

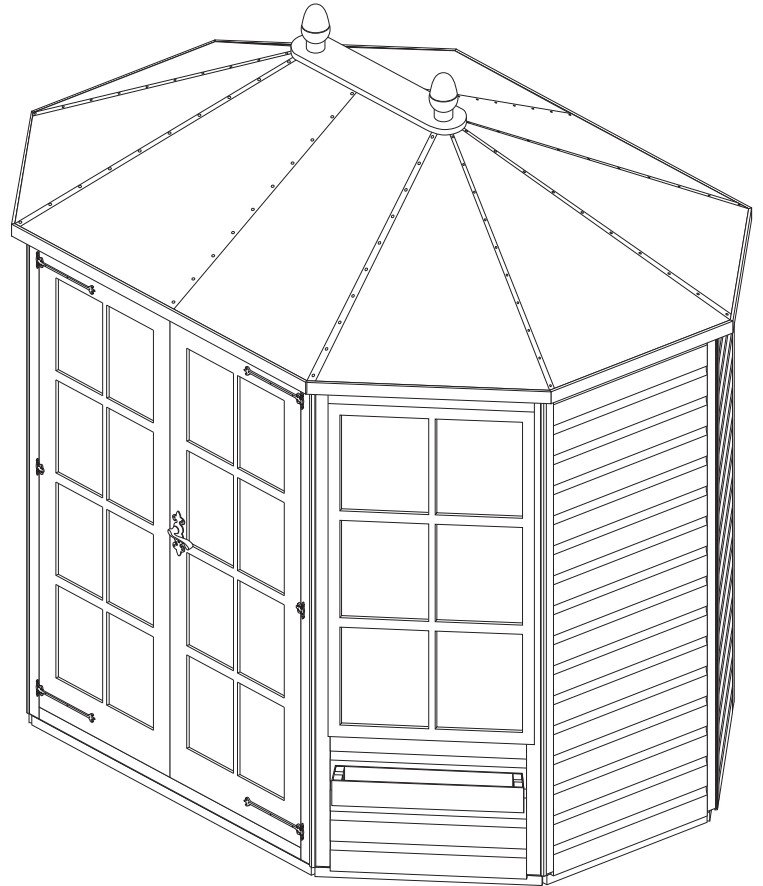

Before assembly

- We recommend that time is taken to read the instructions before starting assembly, then follow the easy step by step guide. The instruction sheet is only a guide to the assembly. Certain items may not be shown to scale.
- Check all components prior to assembly
- This product should be assembled by no less than 2 people.
- Never attempt to erect the assembly in high winds.
- Some of the components may have sharp edges wear protective work gloves while handling components.
- Drill components where indicated.



Recommended tools for assembly

- Cross head screw driver
- Hammer
- Sharp knife
- Drill with 4mm diameter drill bit
- Spirit level
- Silicon sealant
- Step ladder
- Hacksaw

No.	Components	Qty.
1	Floor section	1
2	Back panel	1
3	Plain panel	4
4	Window Panel	2
5	Door panel	1
6	Roof centre support	1
7	Large roof section	2
8	Small roof section	6
9	Left-hand Large roofing felt piece	2
10	Right-hand Large roofing felt piece	2
11	Small roofing felt piece	6
12	Roof top piece with finials	1
13	Short bargeboard	6
14	Long bargeboard	2
15	Coverstrips	8
16	Window box	2
17	Window glazing (615x390mm)	6
18	Door glazing (500x390mm)	8
19	Beading (10x10x615mm)	12
20	Beading (10x10x500mm)	16
21	Beading (10x10x371mm)	28

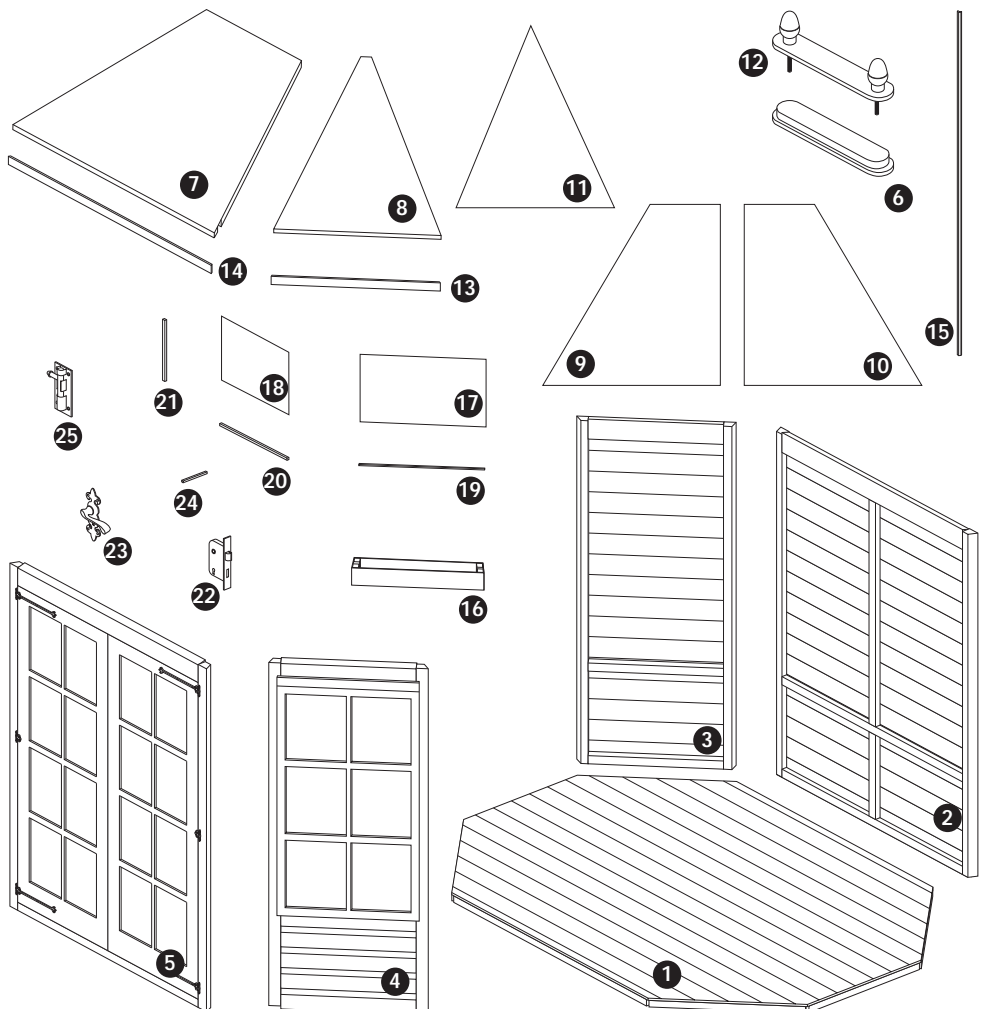

No.	Fixing Kit	Qty.
22	Door lock	1
23	Door handle kit	1
24	Door handle spindle	1
25	Towerbolt	2
26	63mm screws	48
27	32mm screws	8
28	30mm black countersunk screws	8
29	25mm brass screws	4
30	19mm round head screws	8
31	65mm nails	30
32	38mm nails	24
33	25mm nails	32
34	20mm nails	140
35	10mm felt nails	200

1. Floor

Prepare a level area of concrete or slabs for the Summerhouse. Position the base and ensure level

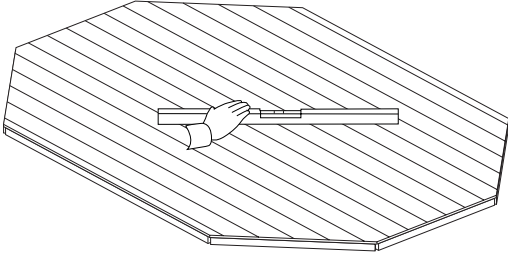

2. Wall panels

Position 2 plain panels on the floor as shown in the first diagram. Note how the panel frames sit on the floor with the panel cladding overhanging the floor edge. Ensure square and secure using 4 x 63mm screws, screw through the frame of the first panel into the frame of the second panel. Align the back panel next to the second panel and secure in the same way using 4 x 63mm screws. Continue to add the rest of the panels in the same way.



Drill the holes in the panel framing with a 4mm drill bit before assembly.

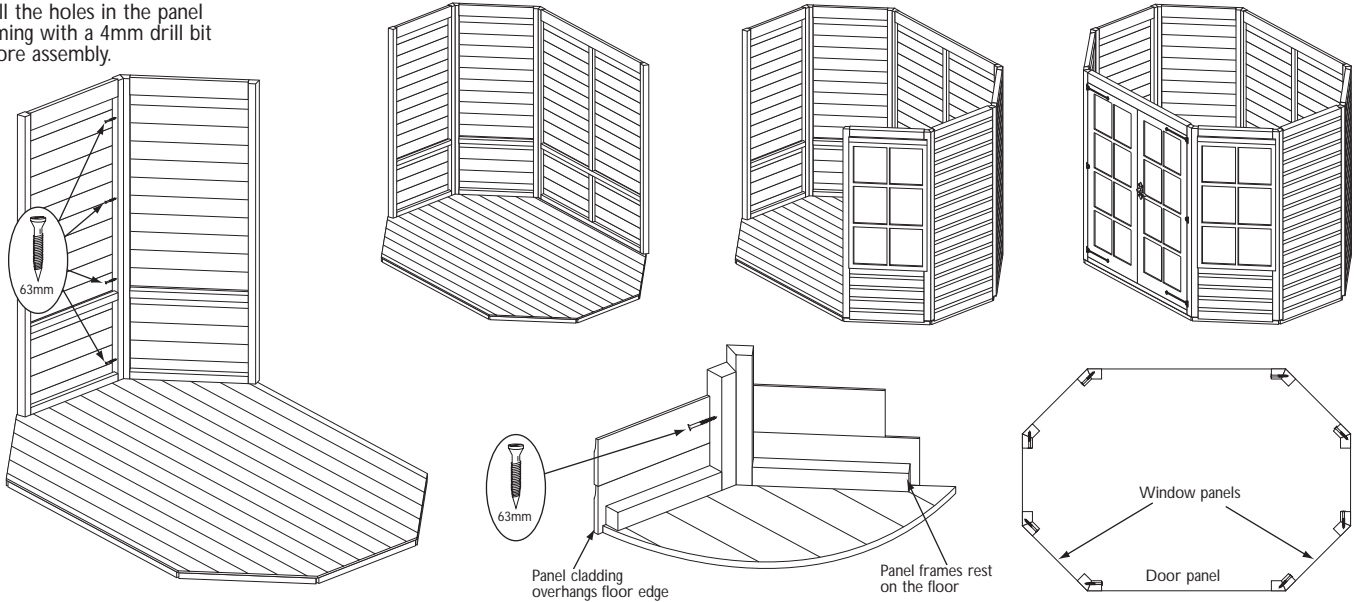

3. Door handle and towerbolts

Push the door lock into the rebate on the edge of the right-hand door as shown and secure using 2 x 25mm brass screws. Push the metal handle bar through the door latch mechanism. Fit a door handle to the metal handle bar on each side of the door and secure them in place using 4 x 30mm black countersunk screws per handle. On the other door fit the lock plate using 2 x 25mm brass screws. Attach the tower bolts to the inside of the left door as shown using 4 x 19mm round head screws per bolt.

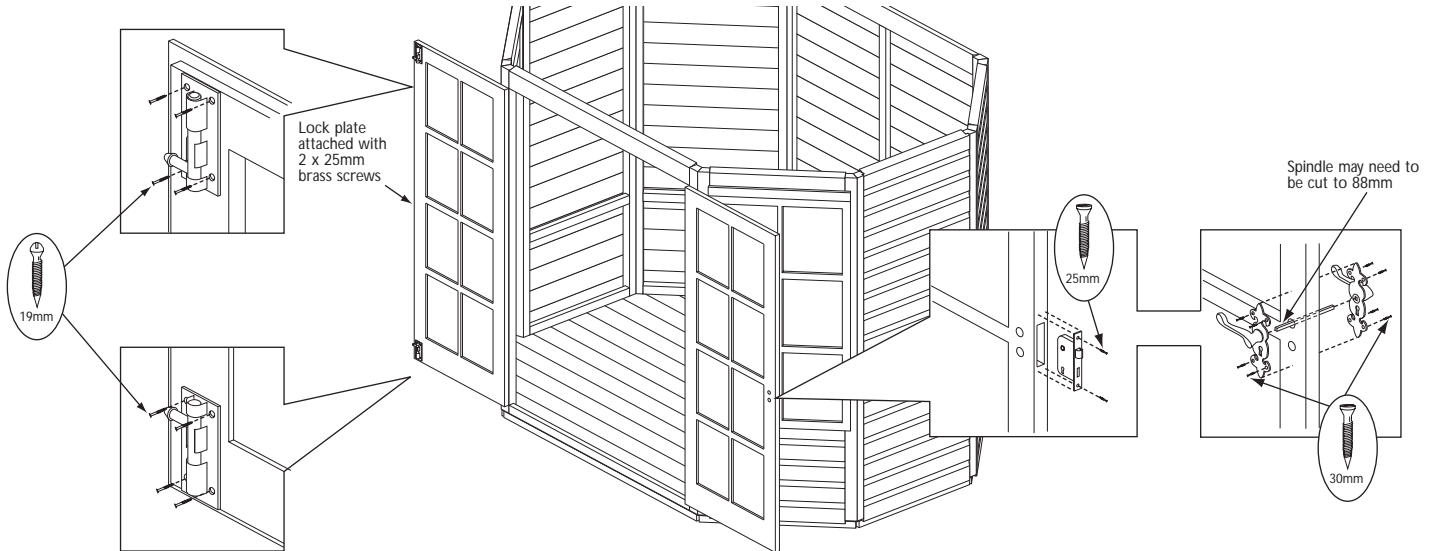

4. Walls to floor

With all the wall panels in position secure the walls to the floors using 2 x 65mm nails per panel, nail through the shiplap cladding of the panel into the sides of the floor.

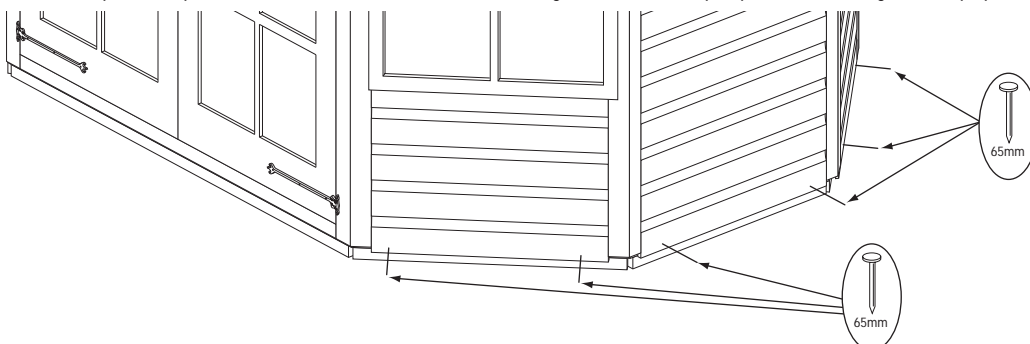

5. Roof

Lift 1 large roof panel onto the back wall panel and the other large roof panel onto the door panel. Position between the top of the 2 roof panels the roof centre support. With a second person holding the centre support start adding the small roof panels. With all the roof panels in position move the centre support slightly up and down for the panels to settle. Making sure all the panels are level, nail through the roof segments into the top frame of the wall panels using 2 x 63mm nails per panel. From inside the building secure the framing of the roof panels together using 2 x 63mm screws per joint.

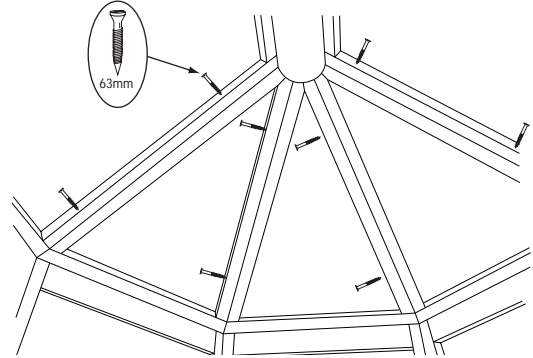
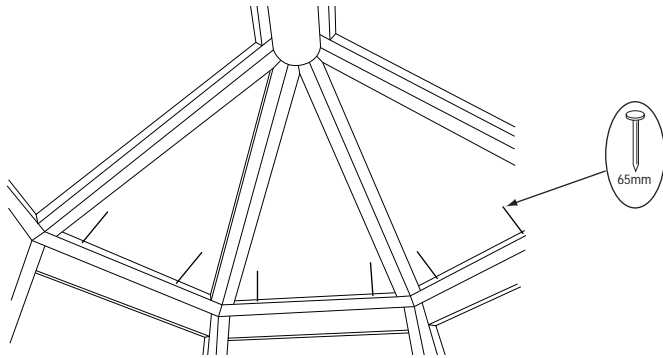
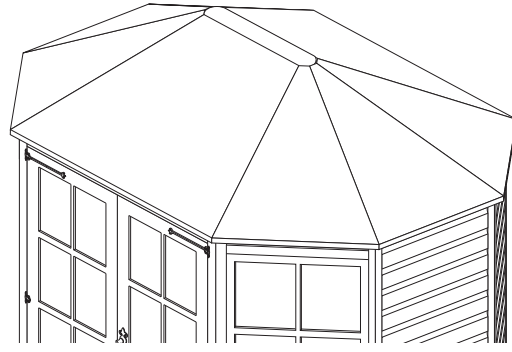
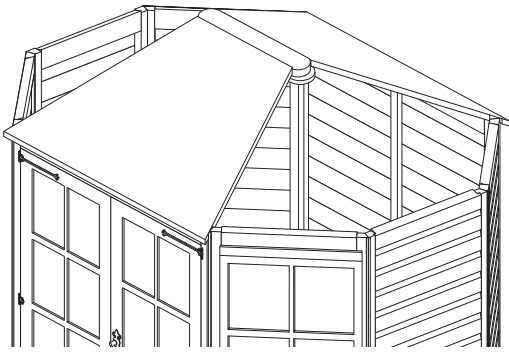

6. Roofing felt

Over a small roof panel lay a triangular felt piece. Align the left-hand felt edge with the edge of the roof panel. Along the bottom edge allow enough felt to fold over and cover the felt batten. The right-hand edge should overlap the next panel round. Once in position secure down the left edge using 4 x 10mm felt nails evenly spaced. Lift back the right-hand edge of the felt and attach another piece of felt in the same way as the first to the next panel round. Roll back into position the first felt. Repeat this for all the small roof panels and in the same way on the left side of each large roof panel with the large left-hand felt piece. Position a Right-hand large on the right side of each large roof panel, ensure it overlaps the felt pieces either side and secure down 1 edge using 10 x 10mm felt nails evenly spaced. For each piece of felt, tension across the roof and secure down the edge using 10 x 10mm felt nails evenly spaced. Fold down the bottom edge of the felt and secure to the felt batten using 5 x 10mm felt nails per felt piece evenly spaced. If necessary trim of any excess felt along the bottom edge.

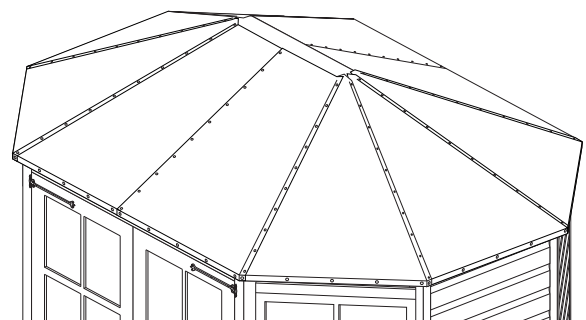
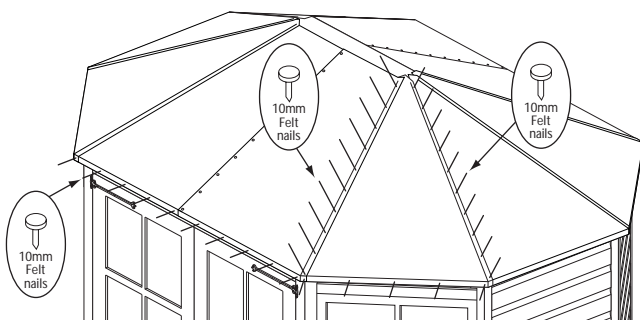
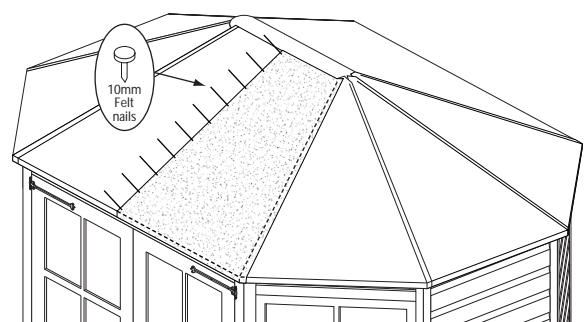
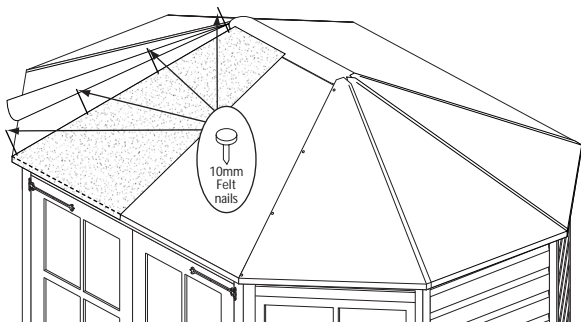
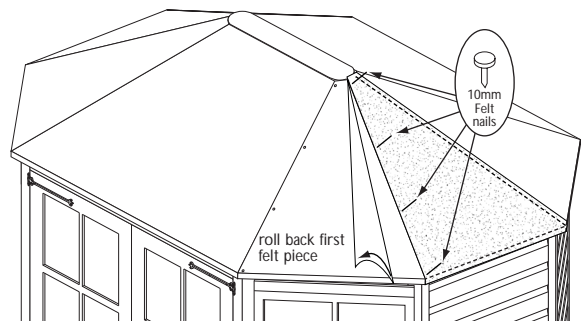
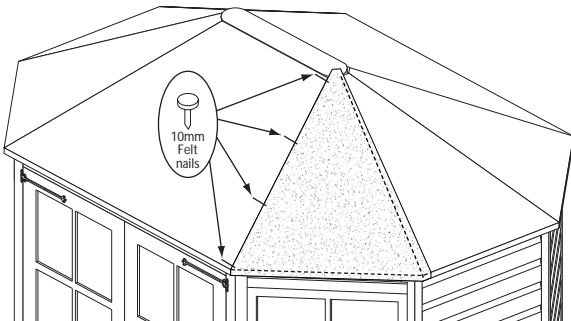

7. Coverstrips, bargeboards and finial

Onto the centre of the roof position the roof top piece with finials, ensure the bolts go through the drilled holes in the roof support and secure the bolts inside the building with the nuts and washers. Around the edge of the roof secure the bargeboards, ensure the top edge of the bargeboards are flush to the roof line and secure each board using 3 x 38mm nails. Attach to each of the 8 corners a coverstrip using 4 x 25mm nails per strip.

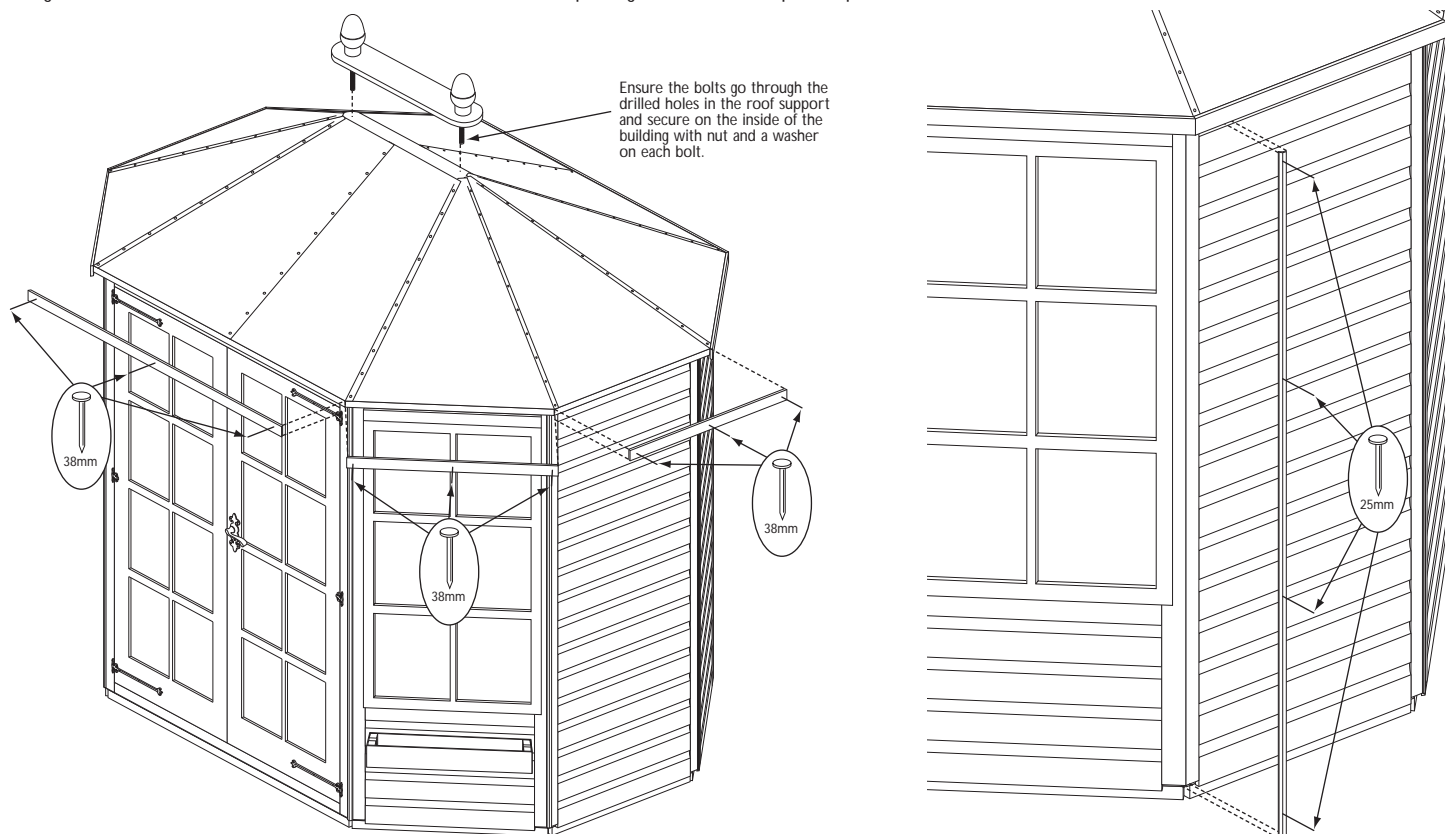

8. Glazing and window boxes

It is recommended that a waterproof sealant is applied around the edge of the glazing before fitting. From the inside of the building fit the window panes into the window frame, fix each window pane in place with 4 window beading strips secured in place using 3 x 20mm nails per beading strip. Locate a window box at the desired height under each window. From the inside of the summerhouse screw through the shiplap cladding into the corner framing of the window box using 4 x 32mm screws per box.



wear protective gloves while handling glazing.

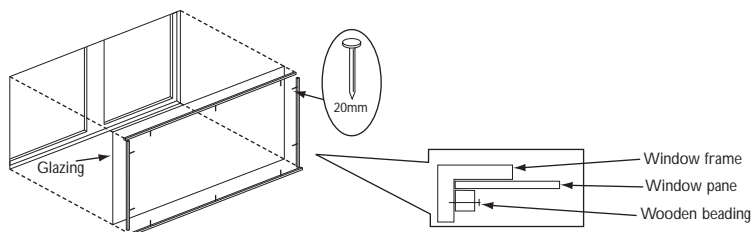

Outside window panel.

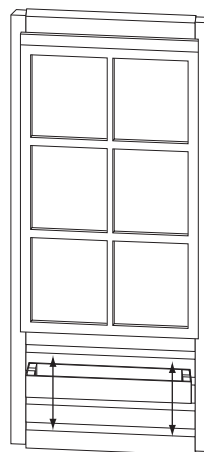

Inside window panel.

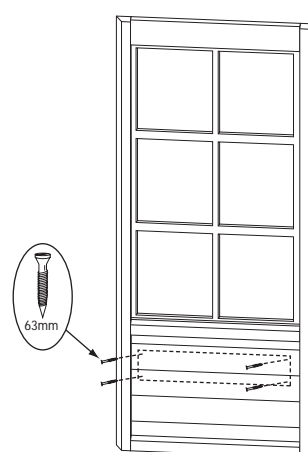

Important information - retain for future reference

Shiplap buildings come ready stained but this is only a preparatory treatment. To **VALIDATE** the guarantee, the building must be properly treated with a recognised external wood preserver **WITHIN 3 MONTHS** of assembly and **RE-TREATED ANNUALLY** thereafter.

Timber Information.

As timber is a natural material, there are certain weather conditions that may affect the materials properties. In times of excessive dry spells the material may lose some of its internal moisture causing a certain degree of shrinkage on a panel and in periods of excessive rain there will be a certain amount of swelling throughout the wooden panels. This process can not be avoided. If you have problems with certain boards shrinking in dry spells try to decrease the amount of direct sunlight on the building or the amount of air passing over the building. During hot spells spray water directly onto the panels with the aid of a garden hose.

If in doubt of any aspect regarding the assembly, use or safety of your building please contact us :

Help Line (Normal Office Hours) 01829 261121

ROWLINSON GARDEN PRODUCTS LIMITED
Unit 2 Green Lane
Wardle Nr.Nantwich
Cheshire
CW5 6BN
Tel : 01829 262080
Fax : 01829 262089

We constantly improve the quality of our products, occasionally the components may differ from the components shown and are only correct at time of printing. We reserve the right to change the specification of our products without prior notice.

2006 © Rowlinson Garden Products Ltd