

LUGARDE



‘SIMPLY THE BEST’

AFFORDABLE QUALITY PRODUCTS FROM HOLLAND

WWW.LUGARDE.COM

LUGARDE, FOR MORE THAN 35 YEARS HAS BEEN YOUR FIRST CHOICE FOR ALL-YEAR-ROUND GARDEN PLEASURE

Lugarde, stands for quality,
service and flexibility

Whether it be a summerhouse, log cabin, garage or veranda, by owning a product from Lugarde you will enjoy many relaxing moments together with your family and friends or you can just relax by yourself in the peace and quiet of your own surroundings.

Custom made at standard prices!

Lugarde produce everything themselves and because of this we are completely flexible to fulfil all your wishes. You can make modifications to all our standard garden buildings or you can create your own individual design. At Lugarde we are here to make your ideas become reality, and all this at no extra charge. Everything is possible and actually nothing at Lugarde is ever standard.

Also available in colour!

For only a small surcharge your summerhouse, log cabin, garage or veranda can now be delivered in colour. You have the choice of 4 different finishes and your garden building will be maintenance free for up to 2 to 5 years (depending on weather conditions).

Endless variety in our program.

We also have a very extensive program in 2 different construction systems. The log cabin system is available in wood thicknesses of 44mm and 68mm and the Lugarde designed 3=1 system is available in 28mm and 44mm.

The 3=1 system is a unique system, whereby you can slide the wall sections into the corner uprights without having to use any nails or screws. These corner uprights are lined with aluminium on the inside creating a very robust construction. We also offer a very

extensive programme of windows and doors.
Available in single or double-glazing.



Log cabin Bordeaux

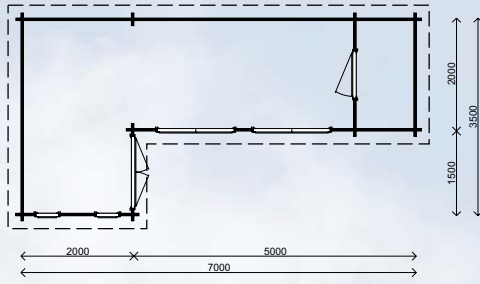

Garage Devon

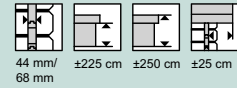
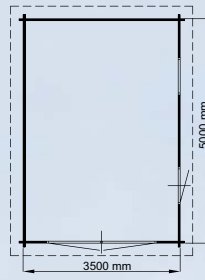

**BORDEAUX
LOG CABIN**

**approx. 350 x 700 cm /
44 mm and 68 mm**

Standard design with 1 double door PE45T, 1 solid door DDo1H, 2 double tilt and turn windows PE48T (opening inwards) and 2 fixed windows PJo6T. Doors and windows are fitted with double glazing. Includes an internal wall measuring approx. 200 cm.

Article number

| | |
|-------|------|
| 44 mm | BB10 |
| 68 mm | BB11 |

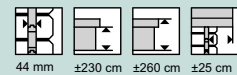

GARAGE DEVON

WITH A FLAT ROOF

**approx. 350 x 500 cm /
44mm**

Standard design with 1 top-hung window PX37, 1 single door PX39 and a pinewood double garage door GDo2.

Article number BGo7

RANGE OF LUXURY 44 MM AND 68 MM GARAGES

Garage Birmingham

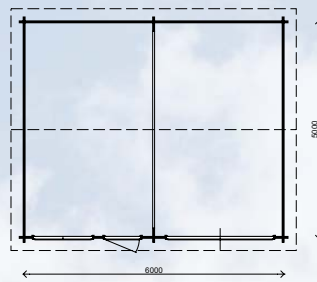

Calais Log Cabin

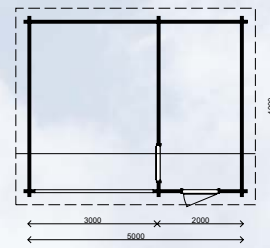

LUGARDE

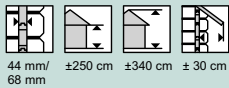

GARAGE BIRMINGHAM

**approx. 500 x 600 cm /
44 mm and 68 mm**

Standard design with 1 double tilt and turn window PE48T (opening inwards), 1 single door PE46T and 1 sectional doors GDo3 (electrically operated incl. 2 remote controls). Door and window are fitted with double glazing. The roof tiles pictured are not a standard feature.

Article number

| | |
|-------|------|
| 44 mm | BG12 |
| 68 mm | BG13 |

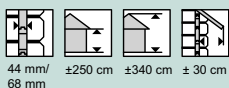

GARAGE CALAIS

**Approx. 400 x 500 cm /
44 mm and 68 mm**

Standard design with 1 single door PX39 and 1 top-hung window PX37. The roof is as standard with an Asymmetric roof. The Calais in this photo is constructed in 68 mm.

Artikelnummer

| | |
|-------|------|
| 44 mm | BC12 |
| 68 mm | BC13 |



* It goes without saying that the log cabins on these pages can also be adapted to your wishes. For further information see pages 54/55.



GARAGE OKLAHOMA

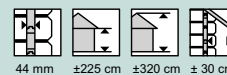

approx. 500 x 550 cm / 44 mm

Standard design with a top-hung window PX37, a single door PX39 and an up-and-over garage door GDO1 clad in hard-wearing red cedar. At the front, this garage features a built-in canopy measuring approx. 200 x 250 cm. Oklahoma is also available as a mirror image; please specify this on your order (no extra charge).

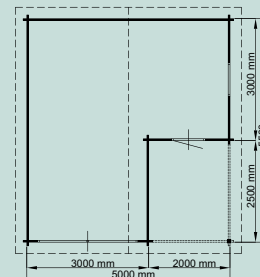

Article number BGo3



GARAGE COLORADO

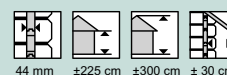

/ 44 mm

Standard design with 2 top-hung windows PX37, a single door PX39 and a double garage door GDO2 (casement doors) with a 28 mm pinewood frame including 19 mm pinewood tongue and groove planking.

Article number

approx. 300 x 500 cm

BGo4

approx. 350 x 500 cm

BGo5

approx. 400 x 500 cm

BGo6

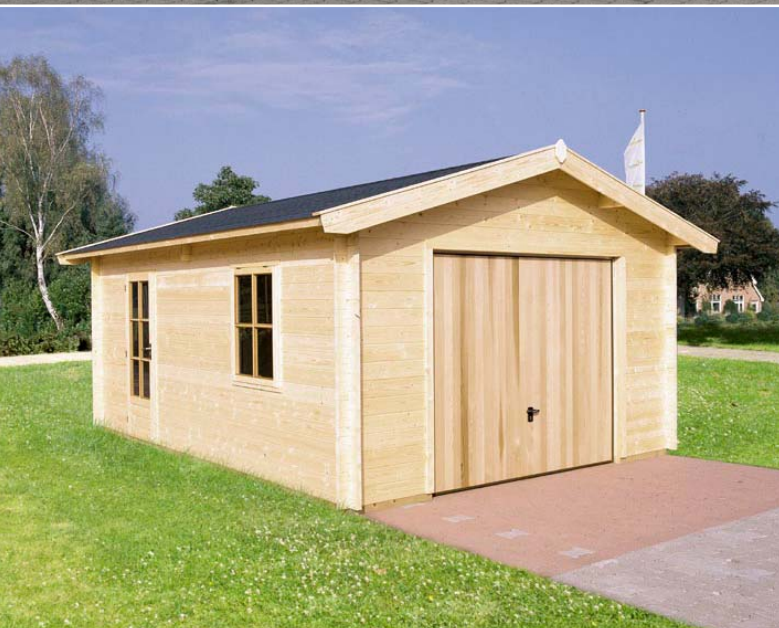
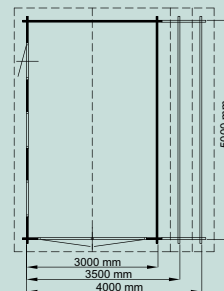

GARAGE KENTUCKY

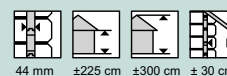

approx. 400 x 500 cm / 44 mm

approx. 400 x 550 cm / 44 mm

Standard design with a top-hung window PX37, a single door PX39 and an up-and-over garage door GDO1 clad in hard-wearing red cedar.

Article number

approx. 400 x 500 cm BGo1

approx. 400 x 550 cm BGo2

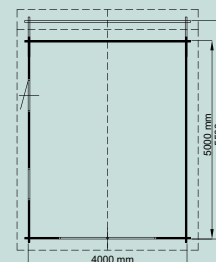



GARAGE MIAMI

750 x 800 cm / 44 mm



44 mm ±265 cm ±400 cm ± 30 cm

Standard design with 1 sectional door GDo3 (electrically operated incl. 2 remote controls), 3 windows PJo7 (with ventilation grate), 1 folding door DL01H and 1 folding door VL02H and 1 solid panelled door DDo3. Folding doors are fitted with safety glass. Includes a built-in canopy measuring approx. 350 x 400 cm and an internal wall as per the drawing. The roof tiles pictured are not a standard feature.

Article number BMo6

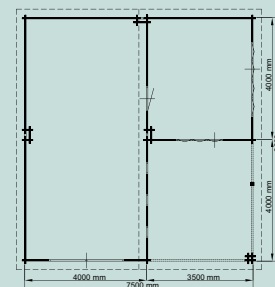

GARAGE KENT

approx. 650 x 500 cm / 44 mm

approx. 650 x 550 cm / 44 mm



44 mm / 68 mm ±265 cm ±400 cm ± 30 cm

Standard design with 2 sectional doors GDo3 (electrically operated, incl. 2 remote controls), a double tilt and turn window PE48T (opening inwards) and a single door PE46T. The window and single door are fitted with double glazing.

Article number

approx. 650 x 500 cm 44 mm

BGo8

approx. 650 x 550 cm 44 mm

BGo9

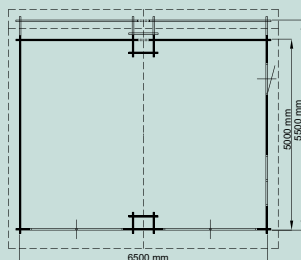

* It goes without saying that the log cabins on these pages can also be adapted to your wishes. For further information see pages 54/55.

SPECIFICATIONS AND OTHER INFORMATION

Premium quality northern European pine is the foundation of all Lugarde summerhouses, log cabins and verandas. In these countries there are strict government regulations in place to ensure that more trees are planted than are chopped down, so that the ecological balance is maintained. Lugarde guarantees that it makes a point of choosing high-quality raw materials and accessories, delivered with expert treatment and handling. Lugarde allows the wood to dry to a moisture content of approx. 12-14% (kiln dried) to prevent the wood from warping as much as possible. All summerhouses and log cabins have been or will be calculated statically.

PRIMA 3=1 SYSTEM SUMMERHOUSES

The walls of the Prima 3=1 system involve a technique, developed by Lugarde, whereby the milled wall sections slot perfectly into the corresponding corner uprights. The corner uprights are fitted on the inside with slide-in aluminium strips, a system that greatly enhances the strength and durability of the summerhouse (no matter what the weather). The Prima 3=1 system is an extremely stable construction that is easy to assemble. The walls are put together without nails or screws, allowing for any warping of the wood (see example of Prima 3=1 system at the front of the brochure).

LOG CABINS

The log cabin system is also a stack wood construction but with chalet milling in the corners, see example on page 57. The log cabins come in a wood thickness of 44 mm but can also be delivered in a wood thickness of 68 mm. Because Lugarde is responsible for all aspects of production, dimensions can be flexible to suit customers' needs. For further information see pages 54 and 55.

INSULATING ROOF AND/OR FLOOR

Depending on what you want to use your summerhouse or log cabin for, you can also have it fitted with roof and/or floor insulation. For a garden shed this is usually not necessary, but if you want your log cabin or summerhouse to serve as a guestroom or office, for example, then insulation is advisable. Floor insulation with a thickness of 4 cm is simple to apply and therefore relatively cheap because the insulation is laid beneath the wooden floor. The roof insulation consists of insulation plates (likewise 4 cm thick), which are installed between the shingles and the roof boards using long clout head nails (included). Other insulation options include double-glazed windows and doors. See page on windows and doors, plus our price list.

WINDOWS AND DOORS

Lugarde has a very extensive range of windows and doors: with and without cross-bars, with single glazing or double glazing, with safety glass, with lead strips, casement windows, top-hung windows, tilt and turn windows, fixed windows, windows with ventilation grates and folding doors. The double frame cross-bars for single & double glazed windows and doors are supplied for both outside and inside and are easy to remove. This is a very useful feature should you want to change the design of your summerhouse/log cabin or if you need to clean or paint the windows/doors.

IF YOU OPT FOR DIFFERENT WINDOWS AND DOORS

If you want different types of windows/doors, then simply substitute the windows/doors you require to your chosen design and add or subtract the difference in costs (See price lists Windows/Doors). All single doors are LEFT-handed as standard; if you want a right-handed door, you must specify this on your order (no extra charge). For double doors, the RIGHT door is the master door.

RAISING WALL HEIGHT

It may sometimes be necessary to raise the height of the walls if, for example, you opt for double glazing or want to interlink various summerhouses or log cabins or if you opt for an attic in a log cabin. Please refer to our price list. E.g. a log cabin measuring 300 x 300 cm: raising by 1 wall section = 12 running metres at per m1.

WINDOW SHUTTERS

The window shutters can be used on (almost) all windows, see photo on page 62 and the price list. Make sure the space next to the window is at least half the width of the window.

DELIVERY ALWAYS ROADSIDE

All products from Lugarde are ALWAYS delivered roadside.

PACKING/KIT INSPECTION

All Lugarde products are packed in environmentally-friendly film that you may be able to re-use. We recommend that you inspect the contents of the kit within 8 days of receipt using the enclosed parts list, and notify your dealer or Lugarde immediately in the unlikely event that anything is missing or damaged.

KIT BAG

The kit bag holds the construction drawing, list of materials, assembly instructions, logbook and all the fastenings. If the construction drawing and/or assembly instructions are missing, call us or download them from our website.



LOGBOOK

When your summerhouse or log cabin is delivered you will receive a logbook (in the kit bag) containing numerous tips and space for notes, e.g., purchase date, wood treatment, colour numbers, paint, dealer's name, type of summerhouse, order number, etc. etc.

GIFT VOUCHER

We always enjoy receiving feedback and photos from our customers' summerhouses or log cabins, and if your photo can be used in our next brochure you will receive a gift voucher worth 85 pounds.

WARRANTY AND COMPLAINTS PROCEDURE

Lugarde grants a 5-year warranty on manufacturing or construction faults; damage caused by humans, animals or natural disasters does NOT fall under the warranty. Complaints as a result of a poorly laid foundation or faulty assembly, poor maintenance and/or the wrong maintenance materials do NOT fall under the warranty (see also maintenance).

ASSEMBLY

Lugarde has a list of select independent assembly companies that can assemble your summerhouse/log cabin for an extra charge and can also lay foundations or carry out any other necessary additional work. For further information, please contact the assembly company yourself.

TIP! Please ensure that there is sufficient clearance (work space) around the summerhouse to facilitate assembly work and (re) treatment of the wood, amongst other things.

PREPARING THE FOUNDATIONS

All summerhouses/log cabins are delivered inclusive of pressure impregnated foundation beams. Any wooden flooring is also supplied with pressure impregnated floor joists. The laying of perfectly level foundations is the most important part of the preparation work for siting a summerhouse or log cabin. If the foundation is not laid correctly problems can occur later, for example, windows and doors may not function correctly and gaps may appear in the wall sections. Depending on the subsoil, remove earth to a depth of around 20 cm, fill in the hole with yellow sand, then compact and vibrate the entire area. Next lay a floor of tiles or concrete slabs – once again the most important thing is to ensure that the entire area is perfectly level. The floor must always be above ground level, and we recommend putting a layer of gravel all the way round the summerhouse to protect it from splashing (rain) water, in case of doubts or queries about the subsoil, you can always call your dealer or Lugarde – please also refer to our logbook.

BUILDING PERMIT

For a summerhouse or log cabin, you are in many cases required to apply for a building permit or you may have a duty to report it. Please contact your local authority for further information or ask your dealer.

TREATMENT AND MAINTENANCE

All summerhouses and log cabins are delivered untreated as standard. We have no control over the elements. Wind, rain and sun have free rein. To provide optimum protection for your summerhouse, log cabin or veranda against the effects of the weather, you must treat the wood as quickly as possible – internally and externally. We recommend treating the wood first of all with impregnating agent after assembly. Then you can treat the summerhouse with non-transparent or transparent dye stain, e.g. from Lugarde. Combining impregnating agent with dye stain provides the best results. Lugarde has developed an excellent system for this purpose together with a well-known paint manufacturer – a system that focuses on quality and care for the environment.

ARRANGE TO HAVE YOUR SCABIN/SUMMERHOUSE/VERANDA IMPREGNATED WITH A CHOICE BETWEEN 4 COLOURS!

You can also have your summerhouse or log cabin impregnated by Lugarde – this is done with a plunge method. First the wood will be pre-treated and then it will be treated with the colour of your choice. The wood is then optimally protected for 2-5 years (depending on weather Conditions). There is then no need to use impregnating agent (see sample colours on pages 80 and 81. Retreating can be done with the same stain or a different colour stain/paint.

For information on the extra charges relating to impregnating, please refer to our price list.

CONFIRMATION OF ORDER TO DEALER

Once Lugarde has sent the dealer written confirmation of the order (normally within 1 week of the order being placed) it cannot be amended free of charge and will be subject to an alteration fee of 50 pounds. Charges will also be made for any order for a summerhouse or log cabin that is cancelled when the order is ready for dispatch.

CALCULATING THE COST OF A LOG CABIN/SUMMERHOUSE/VERANDA YOURSELF

We have put together a chart in the price lists (matrix) to allow you to work out the cost of the summerhouse, log cabin or veranda yourself. Matrix maximum up to 600 cm. Prices for larger log cabins, summerhouses or veranda's are available on request – you can ask for a draft sketch and a quotation. By arrangement, our design department will prepare a design drawing at a cost of 100 pounds; this amount will be refunded to you as soon as the log cabin/summerhouse/veranda has been delivered.

Of course, you can always call, fax or e-mail your dealer or Lugarde for advice. Telephone ++31 (0) 573 401800; fax ++31 (0) 573 401880; or e-mail: sales@lugarde.nl

Models of summerhouses, log cabins and verandas, building systems, construction drawings, photos and/or text in this brochure or on our website must not be borrowed, reproduced or used in any way whatsoever, either in part or in full, without written consent from Lugarde.

Prices, models and materials are subject to change. We accept no liability for printing errors. Lugarde ® and the Prima 3=1 system are registered trade marks.

The Prima 3=1 system is the property of Lugarde ® / Wuestman B.V.

Patent pending EP1 387 912

Brochure issue 2011/2012

Non-transparent stain

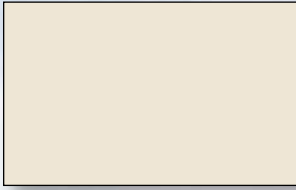

234 Antique white

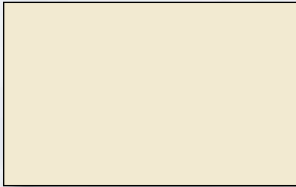

302 Cream



326 Summer yellow

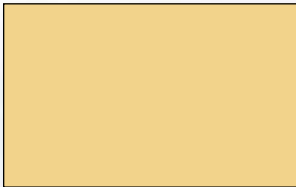

447 Fresco yellow

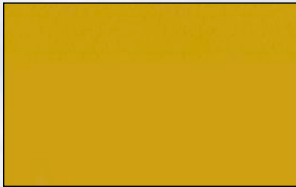

363 Yellow ochre

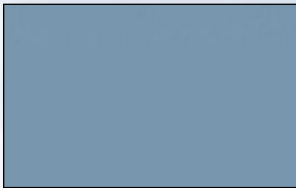

254 Ice blue

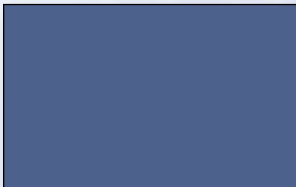

129 Old blue



238 Antique blue



518 Salmon pink



13 Burgundy

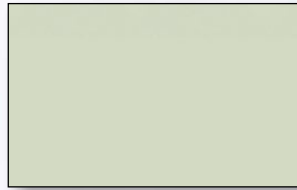

509 Mellow green



506 Old green



206 Dark green

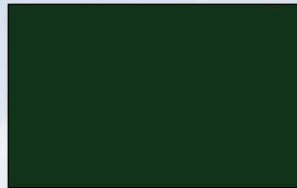

235 Antique green

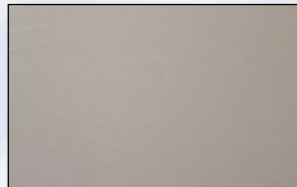

352 Window grey

Transparent stain



217 Pine



232 Oak

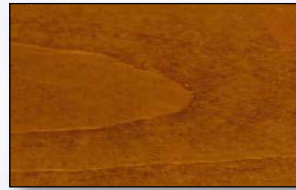

213 Teak

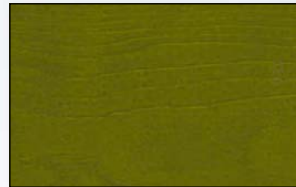

218 Eco-green



Impregnating agent

(colours may vary)

Tip:
Order the paint at the same time as the building, as this will save you shipping costs later.





MG=opal glass. T = thermopane, T-doors standard height 1935 mm. Standard height for single glazing doors is 1800 mm, excluding ph20, ph25, pe50, dd03, mg01, mg02 and all doors with 3 or 4 shutters. All measurements shown are clear opening width.

LUGARDE® LAREN HOLLAND

T +31 (0)573 - 401 800

F +31 (0)573 - 401 880

I www.lugarde.com

E sales@lugarde.nl

LUGARDE



OFFICIAL LUGARDE® DEALER:

© 2011 LUGARDE®